



Skt Kjelds Plads og Bryggervangen

Naturbasert byutvikling

Louise Fiil Hansen
Urban Designer og Partner SLA Norge



Den æstetiske naturfølelse





Design for skiftende regnhændelser

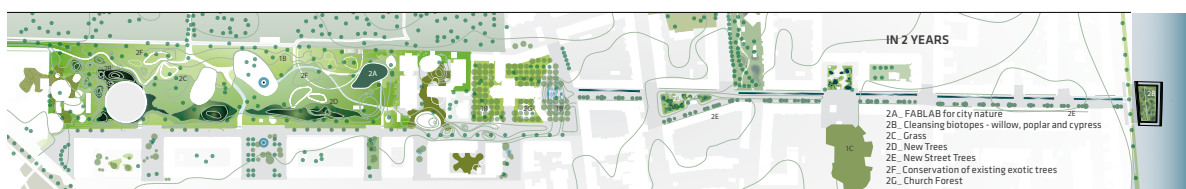
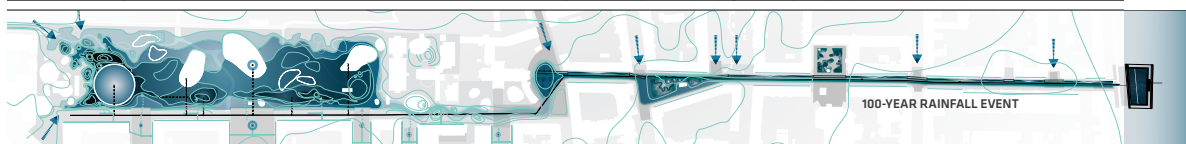
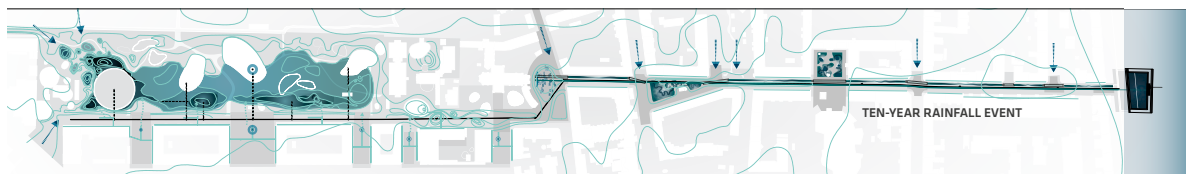
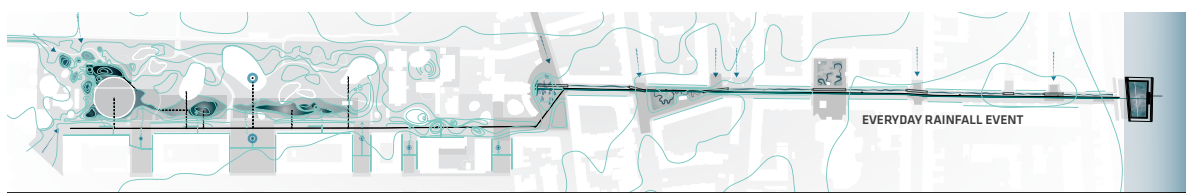

København 2. juli 2011. En 1000-års skybrudshændelse





*400.000 mennesker dør årlig
av luftforurensning i Europa*

(Kilde: European Court of Auditors)

A person wearing a red jacket and a dark hood is walking away from the camera on a cobblestone-paved street. To the right, there is a wall covered in graffiti. The scene is captured in a high-angle, slightly desaturated photograph.

Psykiske lidelser bliver i fremtiden en øget trussel for folkesundheden. Psykiske lidelser påvirker i dag 450 millioner mennesker på verdensplan.

Danske forskere har studeret 1 mio børn og konkluderet at børn, der vokser op omgivet af natur, har reduceret deres risiko for psykiske lidelser med 55 procent.

(WHO and Bioscience Aarhus University, 2019)

IPBES report fra mai 2019 fastslår en global biodiversitetskrise

Human actions are not only a major driving force of environmental change but the source of change in earth system functioning

(Crutzen 2002),

ipbes

The global
assessment report on
**BIODIVERSITY
AND ECOSYSTEM
SERVICES**

Biodiversitet på byutviklingsagendaen

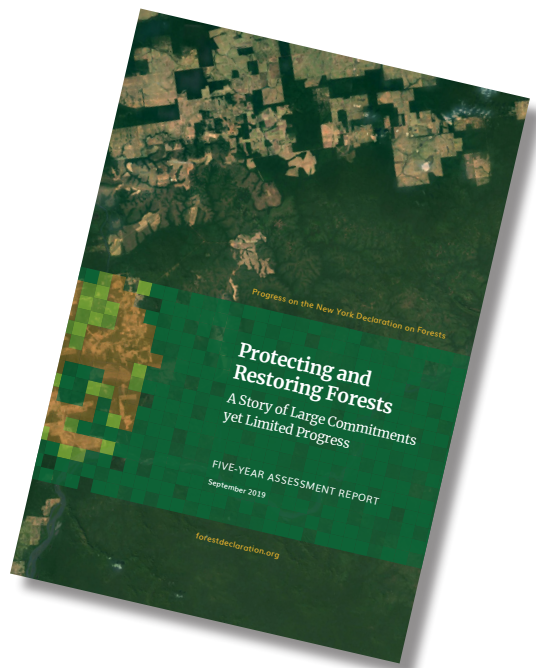

NEW YORK
*City Nature Protection
Strategy*



PARIS
*20 new biodiverse public spaces
by 2020*

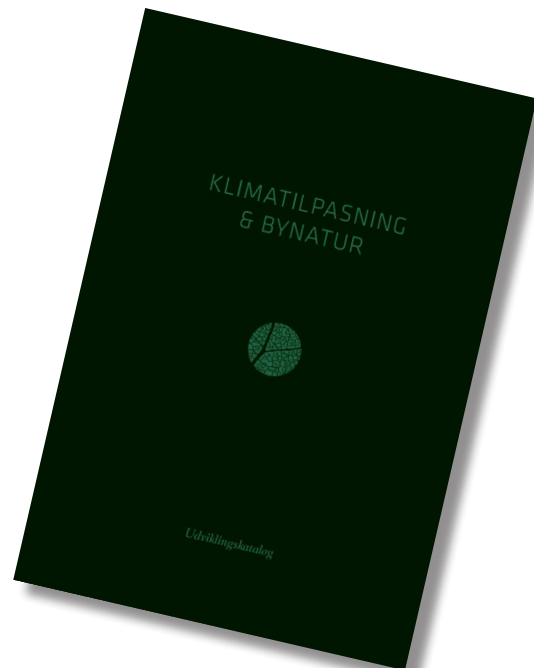

COPENHAGEN
*City Nature and Climate Adaption
- the Copenhagen model*

The business model and 300 projects 2 billion GPB 2013-2033

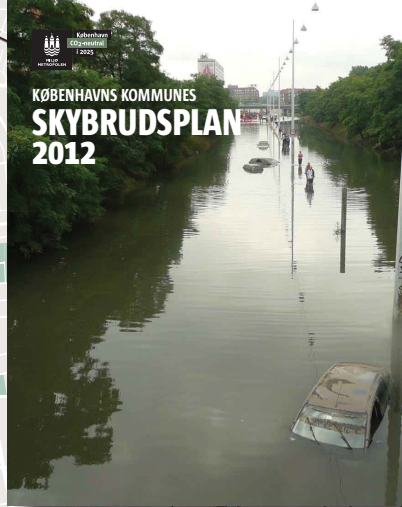

CLOUDBURST/ STORMWATER PLAN

The city of Copenhagen made a stormwater plan, HTP is an existing park in one of the most dense areas of Copenhagen.



Copenhagen Climate Neighbourhood

Hans Tavsens Park & Korsgade

Skt Kjelds Kvarter

*Vi bruker naturen til å løse Skt. Kjelds
Kvarterets utfordringer, samtidig som
vi skaper økt livskvalitet og
sosiale muligheter for alle*

Rethinking the public realm

An architectural rendering of a city block renovation project. The image shows a central intersection with a new pedestrian-friendly street layout. The design features a central green corridor with trees and a water basin. The surrounding blocks are filled with green spaces, trees, and water basins, illustrating a shift from asphalt to green infrastructure. The overall aesthetic is clean and modern, with a focus on sustainability and public space.

600 trees

2/3 asphalt area converted to planting area

+ 500 m³ meter of water basin

New traffic flow

Skt Kjelds Kvarter hovedgreb

Vi omdanner 2/3 av områdets asfalt (9.000 m²) til blågrønne byrom

Vi planter 586 nye trær

Vi skaper + 500 m³ regnvandsbassiner på overfladen

Vi skaper nyt trafikkflow der prioriterer myke trafikkanter

Vi bevarer alle parkeringspladser

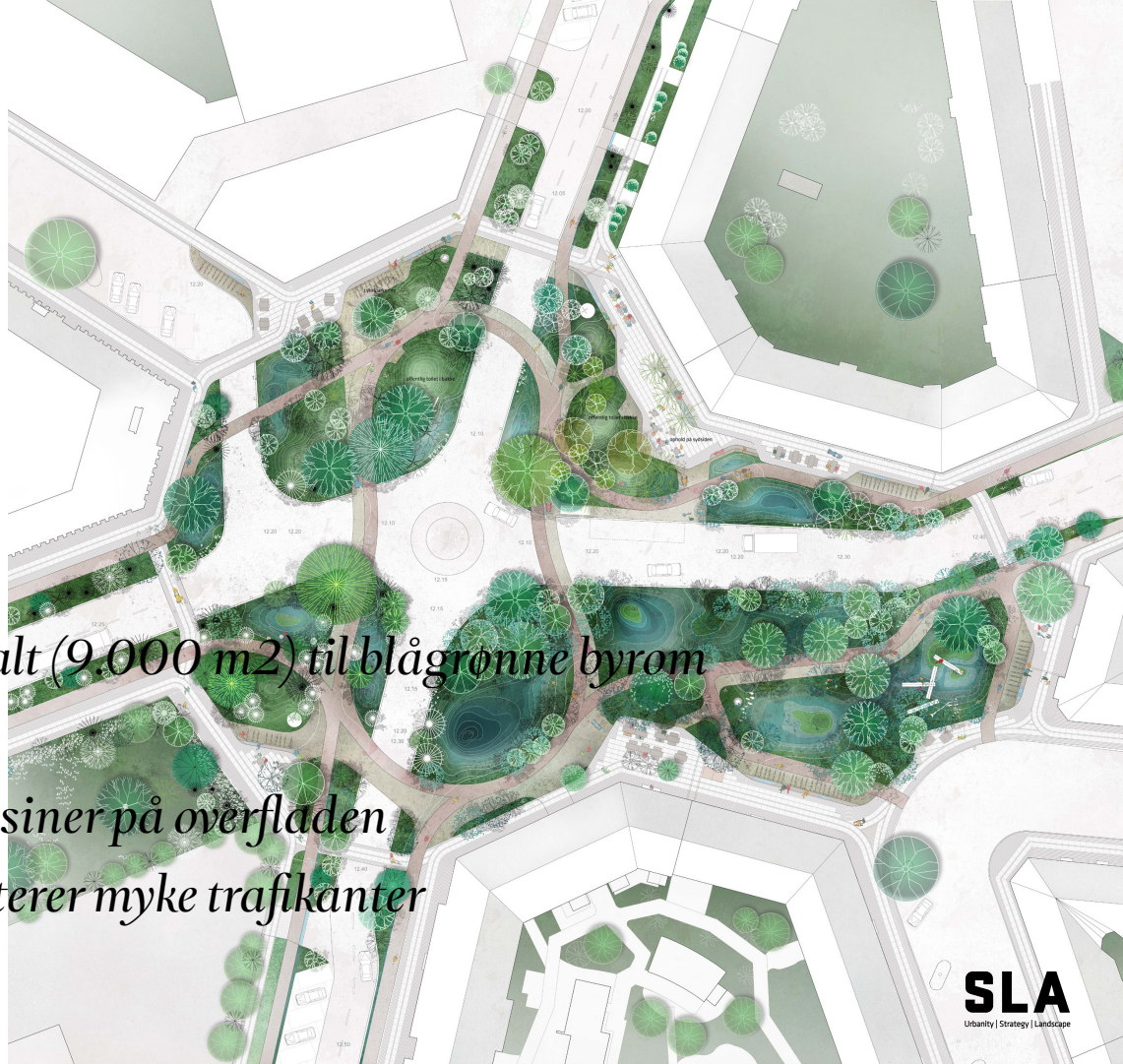

Fra rundkjøring til byrom + mye mer bynatur

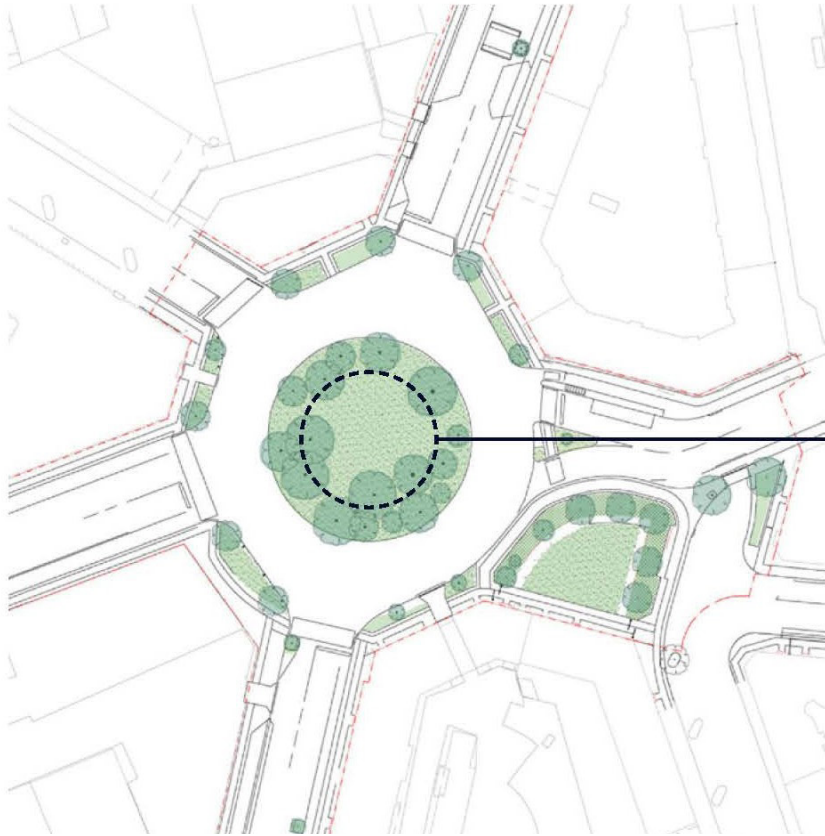

Før

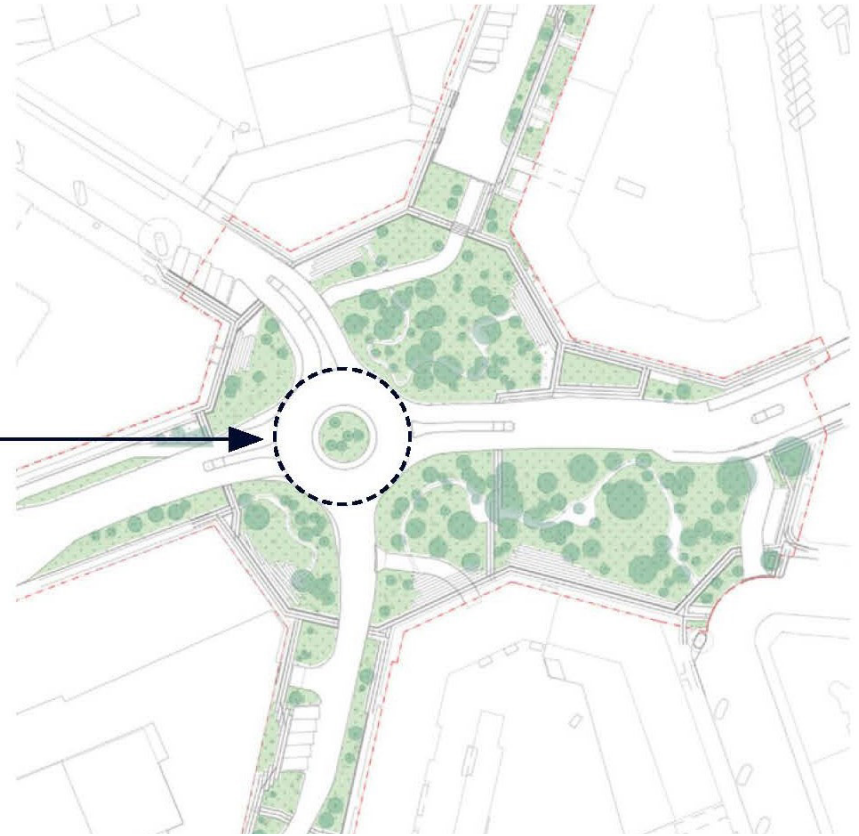

Nu

Vi skaper en ny urban topografi





Skt Kjelds Kvarter for



Skt Kjelds Kvarter før

SLA
Urbanity | Strategy | Landscape



Skt Kjelds Plads januar 2019



Naturen tar byen tilbake

SLA
Urbanity | Strategy | Landscape

The decay of one species gives nutrition to others - nature's succession







Nærhet til naturen, myke trafikanter og luftrensing



Formelle møteplasser og lokalt næringsliv



Uformelle mødesteder og sociale muligheder

Biodiversitet, spredningskorridor og fugleflojtsgaranti



Nytt dynamisk driftparadigme



Naboskab og nabolag



#ViralBynatur

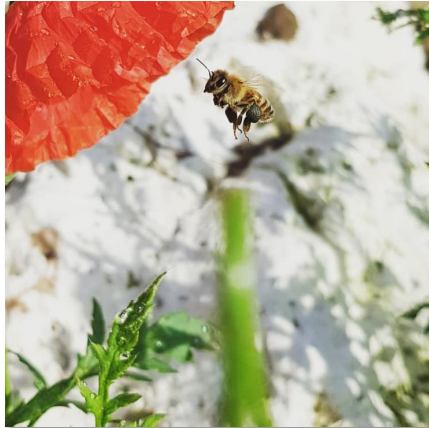
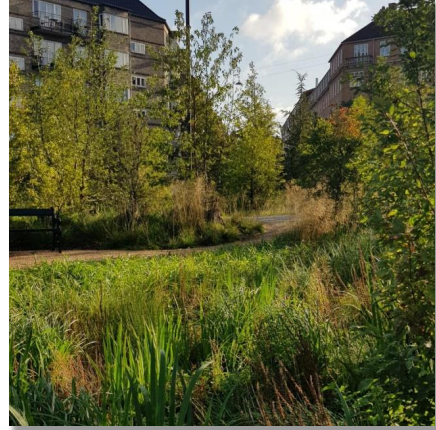

A photograph of a person walking on a series of concrete steps that are partially covered by lush green grass and small flowers. The person is wearing blue jeans and brown shoes. In the background, there are trees, a road, and a building with a sign that says "DIGNABENT". The overall scene is bright and sunny, suggesting a pleasant urban environment.

*En by, der føles
og fungerer
som en skov*